

ELEVATION
SCALE 1:10

NOTES:

1. BRICKS TO BE LAID IN A STRETCHER BOND PATTERN IN ACCORDANCE WITH DESIGN PLANS
2. MINIMUM COMPRESSIVE CONCRETE STRENGTH TO BE 32MPa AFTER 28 DAYS.
3. CHAIRS SHALL SUPPORT THE MESH AT 900mm CENTRES.
4. APPROVED EXPANSION MATERIAL TO BE PLACED BETWEEN BRICKS AND EXISTING OR NEW CONCRETE E.G. KERB AND CHANNEL
5. IN CASES WHERE POOR SUBGRADE CONDITIONS EXIST, CONSIDERATION TO BE GIVEN TO SUBGRADE STABILISATION OR REPLACEMENT
6. NOTWITHSTANDING COUNCIL'S MINIMUM REQUIREMENTS THE PROPOSED CONCRETE SLAB IS TO BE DESIGNED BY A SUITABLY QUALIFIED ENGINEER AS APPROPRIATE FOR THE SPECIFIC SITE CONDITIONS.
7. ALL SOIL TESTING DONE FOR THE PURPOSES OF CONCRETE SLAB DESIGN SHALL BE PERFORMED BY NATA ACCREDITED LABORATORIES, WITH ACCREDITATION TO PERFORM ALL OF THE INDIVIDUAL TESTS THAT ARE REQUIRED. TESTING SHALL ALSO CONFORM TO THE FOLLOWING AUSTRALIAN STANDARDS:
 - AS1726 GEOTECHNICAL SITE INVESTIGATIONS
 - AS1289 TESTING OF SOILS FOR ENGINEERING PURPOSES
 - AS1141 TESTING OF AGGREGATES

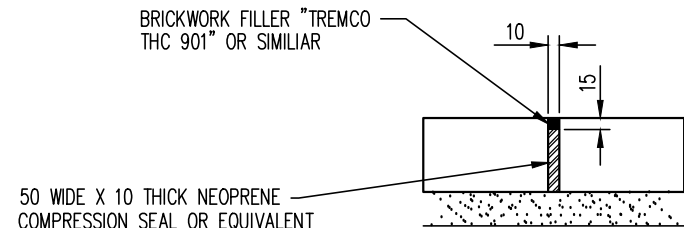

EXPANSION JOINT DETAIL
NOT TO SCALE

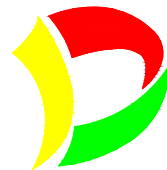

GREATER DANDENONG

**BRICK ROAD PAVING
ON CONCRETE BASE**

LAST UPDATED - MARCH 2015

INFRASTRUCTURE PLANNING

SD 310-B