

TYPICAL FOOTPATH LAYOUT

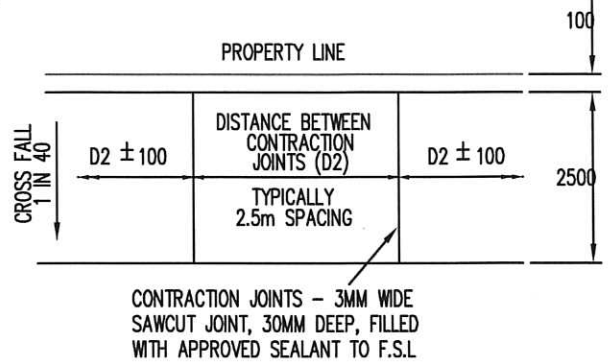

SHARED PATH TYPICAL LAYOUT

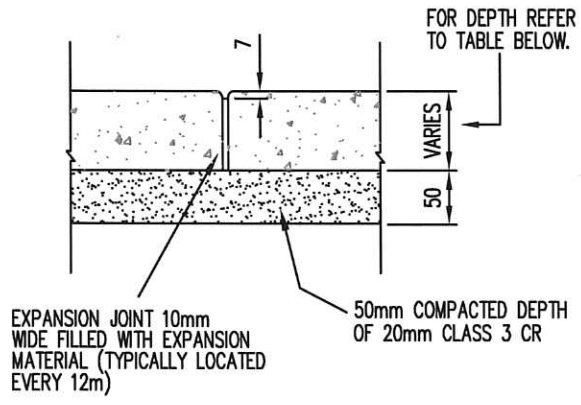

TYPICAL FOOTPATH SECTION

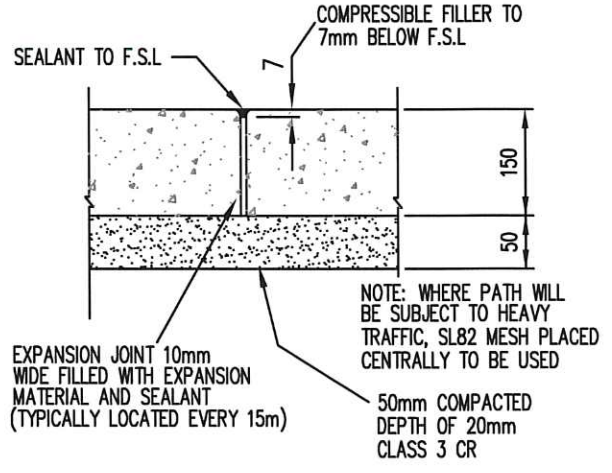

TYPICAL SHARED FOOTPATH SECTION

NOTES:

1. CONCRETE STRENGTH (f_c) IS TO BE 25MPa.
2. NATURE STRIPS AND DISTURBED AREAS ARE TO BE SURFACED WITH 75mm DEPTH OF APPROVED TOPSOIL AND APPROVED GRASS SEED.
3. FOR ALL ANNUAL MAINTENANCE PROGRAM WORKS, EXISTING 75mm FOOTPATHS SHALL BE REPLACED WITH NEW FOOTPATHS TO A MINIMUM THICKNESS OF 100mm. SUPPLY, SPREADING AND COMPACTION OF 50mm THICKNESS OF 20mm FINE CRUSHED ROCK (FCR) BASE MATERIAL IS ONLY REQUIRED WHERE EXISTING BASE MATERIAL IS UNSUITABLE.
4. COMPLIANCE WITH AUSTRROADS GUIDE TO ROAD DESIGN: PEDESTRIAN AND CYCLIST PATHS AND DISABILITY DISCRIMINATION ACT 1992.
5. SL82 MESH TO BE INSTALLED IN SHARED USER AND/OR PARK/OPEN SPACE PATHS SUBJECT TO MAINTENANCE VEHICLE CROSSINGS. MESH TO BE CENTRALLY LOCATED WITH MINIMUM 50MM COVER.

TABLE

| PAVEMENT LOCATION | SLAB THICKNESS | EXPANSION JOINT SPACING (MAX) | CONTRACTION JOINT SPACING (MAX) | CONTRACTION JOINT TYPE |
|-----------------------------|----------------|-------------------------------|---------------------------------|------------------------|
| RESIDENTIAL | 100 | 12m | 1.5m | tooled |
| NEW RESIDENTIAL SUBDIVISION | 125 | 12m | 1.5m | tooled |
| INDUSTRIAL/COMMERCIAL | 150 | 12m | 1.5m | tooled |
| PARK/OPEN SPACE | 150 | 15m | 2.5m | sawcut |
| SHARED USER PATH | 150 | 15m | 2.5m | sawcut |

